

# Specification

## Product ID STG / 0066

### Description

Wessex Mild Steel Bench - Zinc Plated Polyester Powder Coated Finish in a Standard Range Colour - With Iroko Hardwood Timber Slats.

The ends are plasma cut with substantial supporting members for the heavy duty Iroko timber slats. The top and leading edges have a tubular steel section to give a smooth line. The unit is mounted on two closed top tubular legs set at 1200mm centres, each with three distinctive machined grooves to create a design feature.

At the point of ordering please confirm the required fixing arrangement (See Below) and Colour (Refer to colour chart)

On Ground Fix

Below Ground Fix

### Dimensions

If dimensions are critical please contact sales to confirm,

|                             |                |
|-----------------------------|----------------|
| <b>Brand:</b>               | Wessex         |
| <b>Category:</b>            | Seating        |
| <b>Sub Category:</b>        | General        |
| <b>Material:</b>            | Steel / Timber |
| <b>Max Width:</b>           | 1818mm         |
| <b>Above Ground Height:</b> | 460mm          |
| <b>Units:</b>               | Each           |



Image shows Wessex Bench in RAL 9007, Below Ground Fix, with optional arm rests

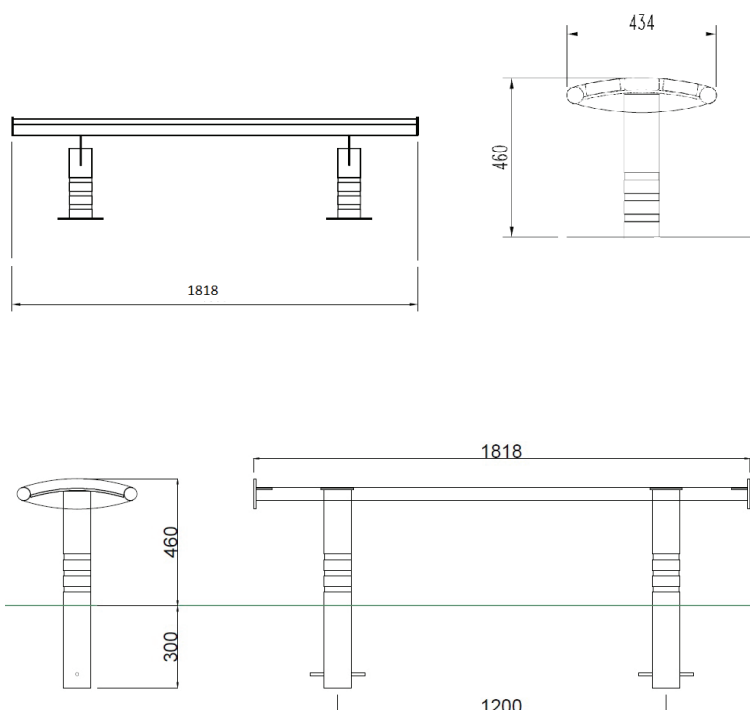

### Policy

Townscape's policy is one of continuous development, and we reserve the right to modify design specification or price without notice. The copyright, design rights and other intellectual property rights in the products and drawings shown and in the text displayed are the property of Townscape Products Limited.

All sizes and weights are nominal and the Company reserves the right to modify dimensions without notice. If dimensions or weights are critical please state when ordering.